

## Don't panic in the event of a sudden power interruption!

Operate the switches in the following order if the ground fault interrupter on your electrical circuit board switches off and the lights in your house suddenly go off.

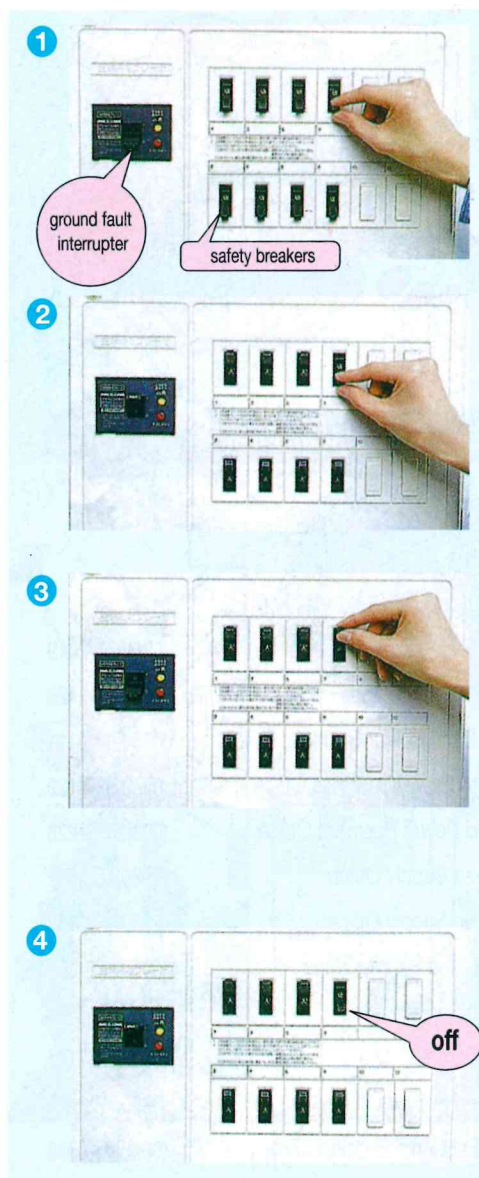

**1** First, turn all the safety breakers to the off positions. The breakers are the line of small switches that are located next to the ground fault interrupter.

**2** Next, move each breaker one by one to the on position after moving the ground fault interrupter to the on position.

**3** If the ground fault interrupter shuts off as soon as you have moved a breaker switch to the on position, that circuit has faulty wiring or an appliance has a short circuit. Contact an electrician immediately to replace any faulty wiring. Don't use a short-circuited appliance and have it repaired.

**4** Leave the faulty circuit breaker in the off position and move the ground fault interrupter switch into the on position again. You can use the other circuits except for the faulty one if their breakers stay in the on position.

Contact OEPC if the ground fault interrupter switch does not stay in the on position after completing step **1** above.